

URBANI DVOETAŽNI STAN S1 + vrt i 2 parkirna mjesta, 2.250€/m² (prodaja), Koprivnica, Flat

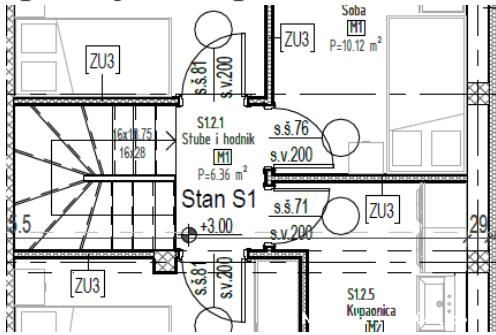

Seller Info

Name: Boris Vrtiprah
E-mail: info.savjetovanje@gmail.com
First Name: Boris
Last Name: Vrtiprah
Country: Croatia
Region: Koprivničko-križevačka županija
City: Koprivnica
City area: Cinderišće
ZIP code: 48000
Address: Mariškina ulica 12
Phone: 099 66 95 358
Mobile: 0996695358
Privacy Policy:

Listing details

Common

Title: URBANI DVOETAŽNI STAN S1 + vrt i 2 parkirna mjesta, 2.250€/m² (prodaja)
Property for: Sale
Property area: 97.25 m²
Floor: 2
Number of Floors: 2
Bedrooms: 5
Bathrooms: 2
Garden area: 19.85 m²
Terrace area: 19.85 m²
Price: 218,813.00 €
Cellar: no
Updated: Aug 22, 2024

Orientation

Orientation: East, West, South

Condition

Newbuild: yes
Built: 2025
Condition: Under construction

Location

Country: Croatia
State/Region/Province: Koprivničko-križevačka županija
City: Koprivnica
City area: Cinderišće
Quarter: Cinderišće
Address: Mariškina ulica
ZIP code: 48000

Permits

Building permit: yes
Location permit: yes
Ownership certificate: no
Inspection certificate: no

Additional information

Infrastructure: Water, Active telephone line, Video intercom, Smart house, Air conditioner, Electricity, Telephone installation, Sewage, ADSL, IT network
Access with vehicle: Car
Elevator: no
Freight elevator: no
Energy efficiency: A

Heating

Central heating: yes
Heating type: air-conditioner, boiler house
(substation) electrical



Parking

Garage: no
Number of parking spaces: 2
Covered parking space: yes

Description

Description: URBANA VILA/STAN S1 Prodaje se urbani dvoetažni S1 na atraktivnoj i mirnoj lokaciji – Mariškina ulica (Cinderišće) u Koprivnici. U gradnji i opremanju zastupljeni su međunarodni standardi visokog stupnja. Nekretnina je opremljena dizalicom topline i podnim grijanjem. S1: 89,01 m² stambene površine + 19,85 m² vrt-dvorište + 2 parkirna mjesta (ukupne površine 25m²) PRIZEMLJE: Hodnik 4,84 m² WC za goste 1,49 m² Kuhinja 7,12 m² Dnevni boravak, blagovaonica i stubište 31,35 m² =44,80 m² KAT Stube i hodnik 6,36 m² Kupaonica 7,73 m² Soba1 9,80 m² Soba2 10,12 m² Soba3 10,20 m² =44,21 m² S1 DODATNO

Parking1 12,50 m² X 0,25 koef. = 3,125 m² Parking 2 12,50 X 0,25 koef. = 3,125 m² Vrt 19,85 X 0,1 koef. = 1,985 m² = 8,24 m² S1 UKUPNO = 89,01 m² + 8,24 m² =97,25 m² Početak gradnje 07/2024. godine, a planirani završetak 07/2025. godine. Za više informacija i mogućnost dogovora te prezentacije projekta, slobodno se obratite na 099/6695358. CIJENA: UKUPNO NETO =97,25 m² x 2.250,00 EUR/m² =218.812,50 EUR Do 30.9.2024. moguće je dogovoriti popust na kupnju u preprodaji.

Additional contact info

Reference Number: 634142
Agency ref id: MAR.12
Contact phone: +385 (99) 669-5358