

OPATIJA, Travičići, građevinsko zemljište 1500m m2 započeta gradnja, Opatija - Okolica, Arazi

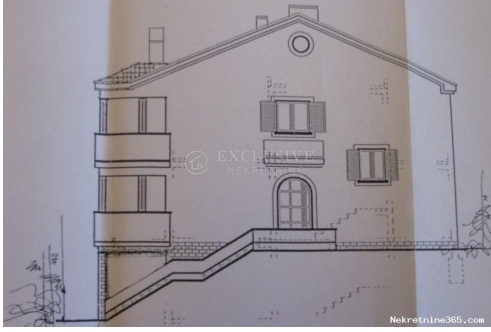

Satıcı Bilgisi

| | |
|---------------|---|
| Ad: | Exclusive Nekretnine |
| Ekle: | Exclusive |
| Soyad: | Nekretnine |
| Firma Adı: | Exclusive nekretnine d.o.o. |
| Service Type: | Selling and renting |
| Web Sitesi: | https://www.exclusive-nekretnine.hr |
| Ülke: | Croatia |
| Region: | Primorsko-goranska županija |
| City: | Opatija |
| City area: | Opatija |
| Posta Kodu: | 51410 |
| Adres: | Maršala Tita 65 |
| Mobile: | +385(0)91/887-5855 |
| Phone: | +385(0)51/498-068 |
| Hakkımızda: | Founded in 2017 and situated in the heart of Opatija, on Maršala Tita Street No.65, and Kralja Tomislava 2 Crikvenica theExclusive nekretnine d.o.o has operated successfully in the entire area of Opatija,Rijeka,Crikvenica,Krk and his surroundings. In compliance with the Law of Intermediation on Real Estate, the Agency performs all required judicial activities to allow the most convenient market price at the moment of the real estate purchase and sale. |

The Agency is a real estate licence holder and signatory to the Code of Business Ethics of the Croatian Chamber of Commerce. Its main activities consist of purchase intermediation, rental, sale and exchange of real estate

properties.

In addition, the Agency collaborates with external experts on matters of real estate evaluation and Energy Performance Certification.

For all our clients, we perform a complete verification of the official documentation found in the Land Registry as well as in the Cadastral records, from which we certify the property of the real estate.

Liste ayrıntıları

Genel

| | |
|-------------|---|
| Başlık: | OPATIJA, Travičići, građevinsko zemljište 1500m m2 započeta gradnja |
| Emlak: | Satılık |
| Arazi tipi: | Şantiye |
| Metre Kare: | 1500 m ² |
| Fiyat: | 120,000.00 € |
| Gönderildi: | 19.03.2024 |

Konum

| | |
|----------------------|-----------------------------|
| Ülke: | Croatia |
| Eyalet / Bölge / İl: | Primorsko-goranska županija |
| Şehir: | Opatija - Okolica |
| Şehir alanı: | Veprinac |
| Poštanski broj: | 51410 |

İzinler

| | |
|-------------------|------|
| İnşaat ruhsatı: | evet |
| Yer izni: | evet |
| Sahiplik belgesi: | evet |



Tanım

| | |
|-----------|--|
| Ek bilgi: | Građevinsko zemljište za gradnju dvojne kuće za turizam ili dvojnju obiteljsku kuću, započeta gradnja za dvojnju vilu S+P+1. Izveden prilaz, temelji, ploča, 1500 m ² zemljišta sa pogledom. Objekt 350 m ² bruto. Sva davanja plaćena kao i Glavni projekti. Uskoro direktan prilaz na glavnu cestu Matulji-tunel Učka. Nekretnina vrijedna pažnje. PRILIKA!!! PREPORUČAMO!!! ID KOD AGENCIJE: 2103 |
|-----------|--|

Ek iletişim bilgileri

İç referans numarası: 580704
Agency ref id: 2103
İrtibat telefonu: +385 (0) 91 466 5664